

■ Construction and Features of Gearhead

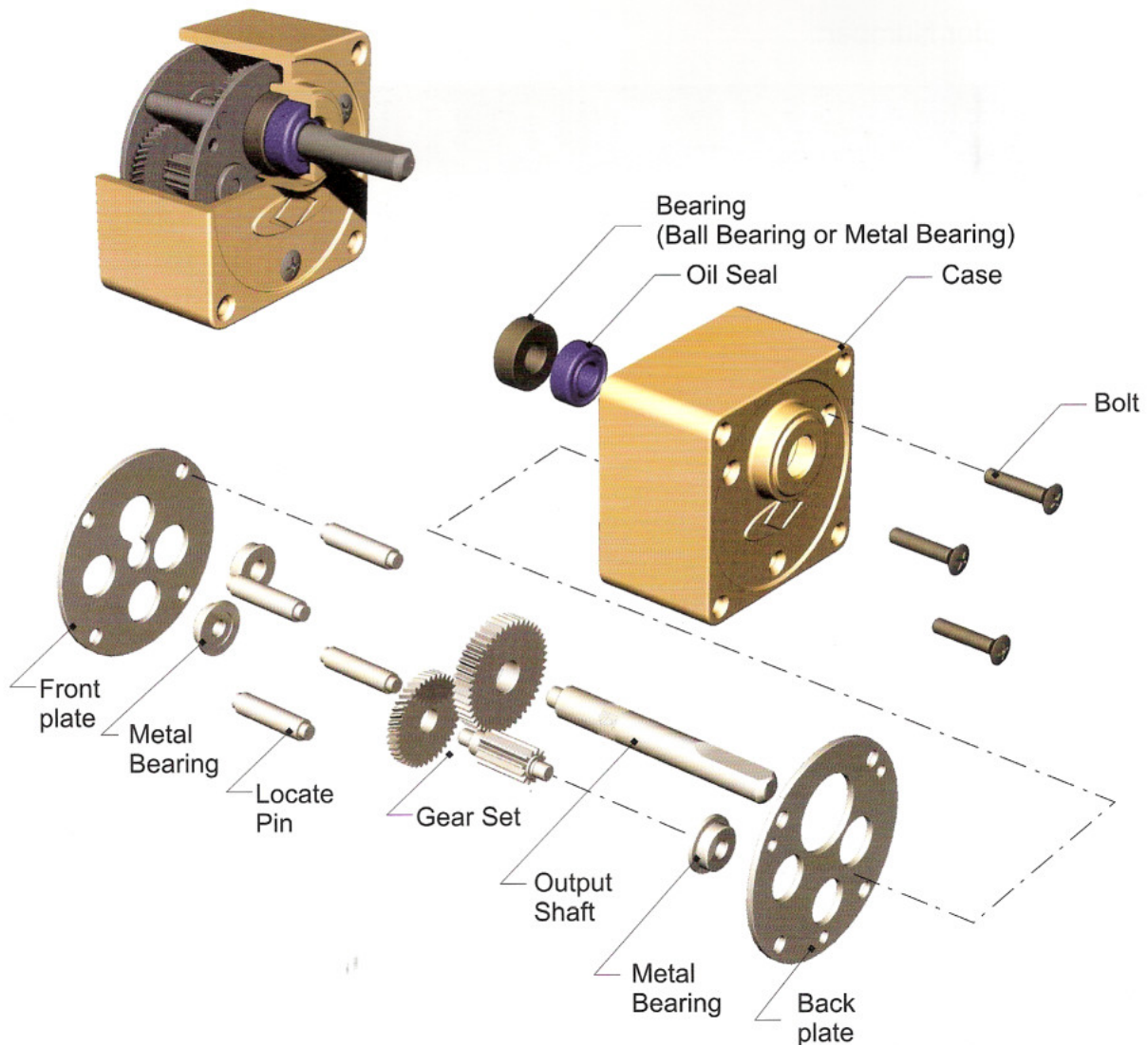

■ Precise

All gears conforming with JIS Class-4 AGMA Class-8, results in extremely smooth and quiet operation.

■ Durable and Reliable

With ball bearing structure, MTBF - 5000 hours guarantee is ensured by our rigorous Quality Assurance System.

■ Quiet and Smooth

With oil seal hermetically sealed structure, highly precise helical gear sets and specially high performance grease, gears entirely get lubricated, by which prolonged the lifetime and reduced the noise and power loss.

■ Computer Integrated Design and Manufacturing

Through CAD system simulation, Gear Matching Test, Spectrum Analysis and Dynamometer system confirm the quality of design and manufacturing have brought us about immense innovation in the field of gear industry.

■ Customer Orientation

With the unique technology of designing and manufacturing, we are able to achieve not only standard products but also custom - made products to meet the comprehensive demands of the market.

■ Innovation and Revolution (PAT. No 068384)

Brand - new appearance and special designs in patent have vitalized our products, with the commitments of "Precise, Expandable, Excellent, Instant", we should be the best partner to work together to expand the worldwide market.

■ Coding - Gearhead

Gear Head Number:

G - 2 N 3 - K H

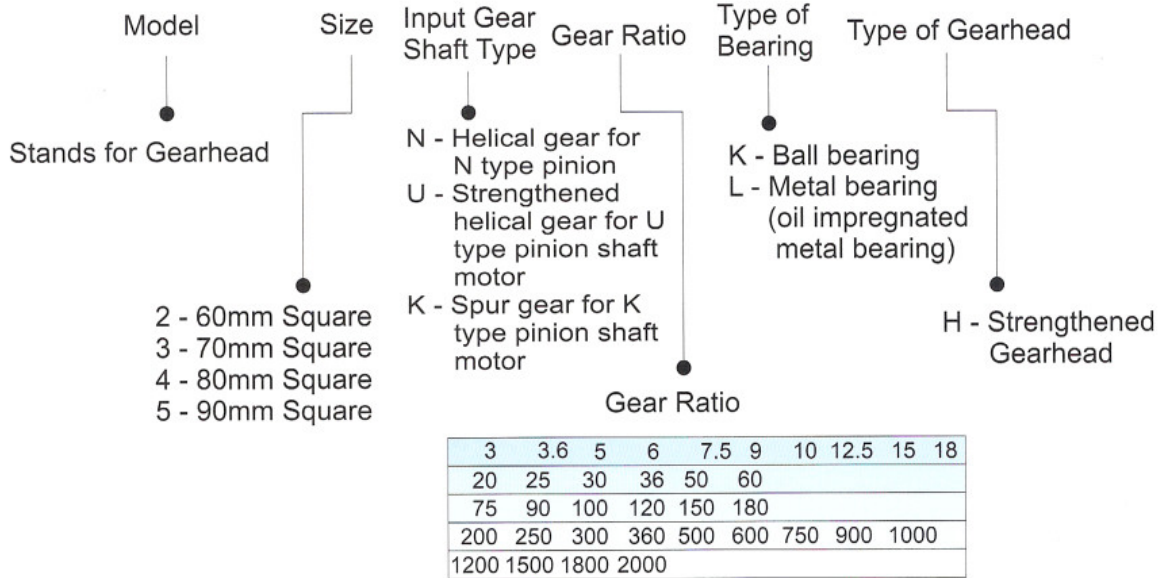

Rating Label:

